

Array 3x

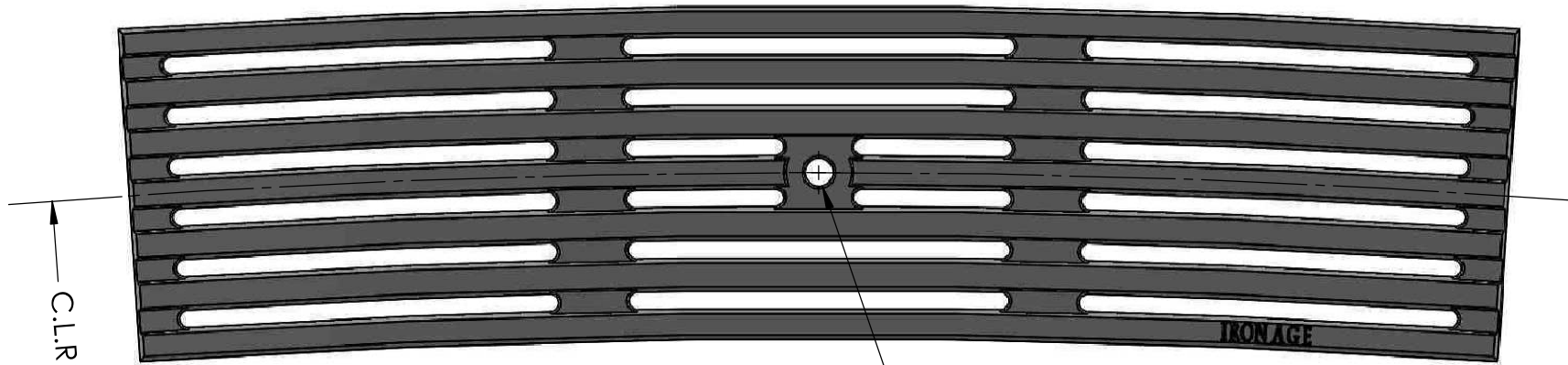

Top



C.L.R 12'-2.86"

hole for 5/16-18 bolt

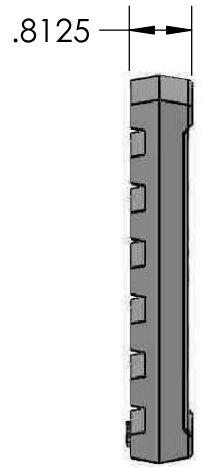

.8125

Edge



Side

 **IRON AGE** 2104 SW 152nd St #4 TEL 206.276.0925  
**DESIGNS** Burien, WA 98166 FAX 206.257.0318  
 www.ironagedesigns.com

Que 5" Heel-Proof Trench Grate  
12'-3" C.L.R.

Drawn by: CD  
Date: 5/23/16  
Scale: Not to Scale

DWG. NO. 01-3A-QUE.1.5x20R12'3"

NOTES:

1. Material: cast iron
2. Finish: Raw
3. Edge thickness: 13/16"
4. Fits frame by: Iron Age
5. Heelproof; No openings greater than 1/4"
6. Weight approx. <13lbs
7. Due to casting inconsistencies all dimensions are nominal

© 2016 Iron Age Designs